



最高额定电压为160kVDC 的 CA28型插头

在空间受限的环境中，Claymount公司生产的CA28型平口高压连接系统可作为插头型连接系统的替代选择。提供扁平连接器和插口，可支持最高电压 $\geq 160\text{kVDC}$ 。

特点

- 节约空间的平口连接技术
- 高柔性电缆的额定电压为160 kVDC，屏蔽覆盖率达95%
- 连接器额定工作温度为80°C，配备有可替换触头。

说明

连接器采用铝（外壳）金属制成，采用环氧高压灌注材料，具有绝佳的绝缘特性。

在处理期间如果发生损坏，三个镀金插头可随时替换。

为了保证界面能够具有合适的电气强度，在两个扁平接触面间配备有一个硅橡胶垫圈。该垫圈被紧压在两个扁平接触表面间。通过在4个螺栓上使用专门的扭矩将连接器紧固到插座插口来获得所需触点压力。

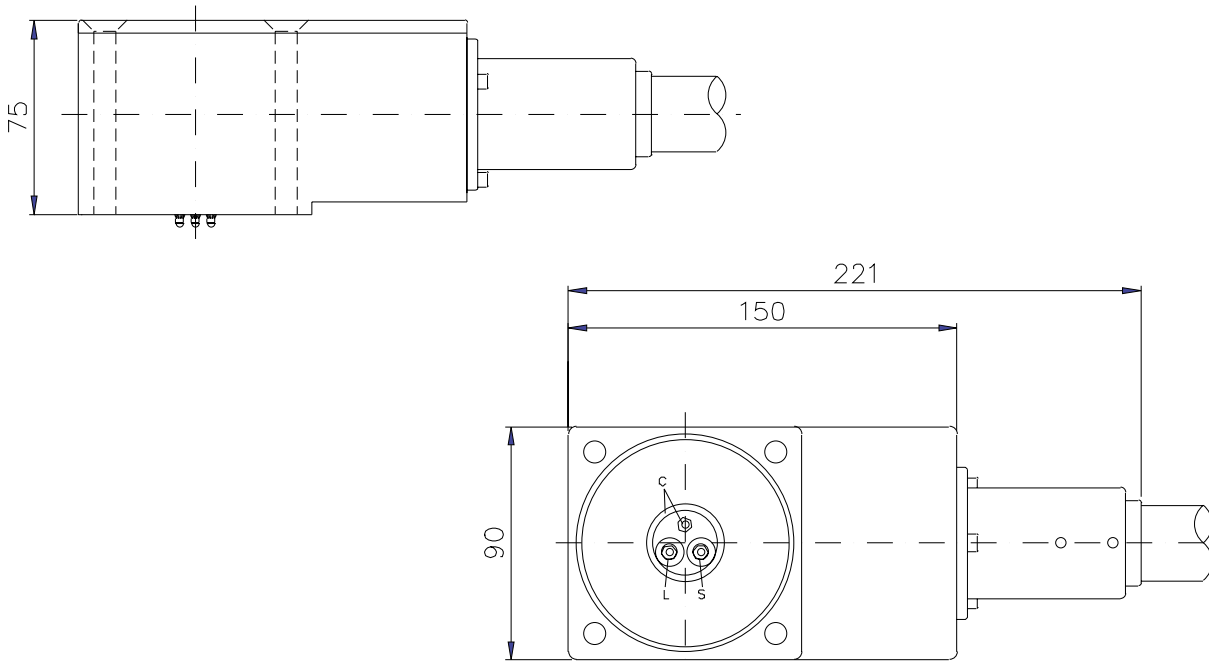

Cable types

The following cable types can be terminated with CA28-type connectors

N3 (3 conductors, 160kVDC)

Technical data

Voltage rating	160 kVDC
Maximum voltage between conductors	3 kVDC
Number of contacts	3
Maximum conductore current @ 40°C ambient temperature	15 A
Maximum operating temperature	At least(*) 80°C
Minimum storage temperature	-10°C
Washer thickness	5.5 mm
Fastening hardware (qty x 4)	M8 x 90
Fastening bolt torque	15 Nm - 16 Nm
Washer contact pressure	~3 N/mm ²
Connector weight	~2.2 kg

Installation preparation: Thin layer of silicone grease, Wacker Chemical Corp. Part number "P4" or equivalent on both sides of the interface washer

(*) Current applications run at 80°C max, no field experience with higher temperatures

Type tests

Overvoltage test 200 kVDC for 10 hours at room temperature	Passed
Overvoltage test 180 kVDC for 100 hours at room temperature	Passed
Heat cycle test, -20 to +120°C, 10x, followed by 180kVDC for 3 minutes	Passed
Thermal test 120°C for 5 hours	Passed